

Bed Ends - Manual & Semi Electric 5200 2 Crank Hi / Lo

discontinued 6/03

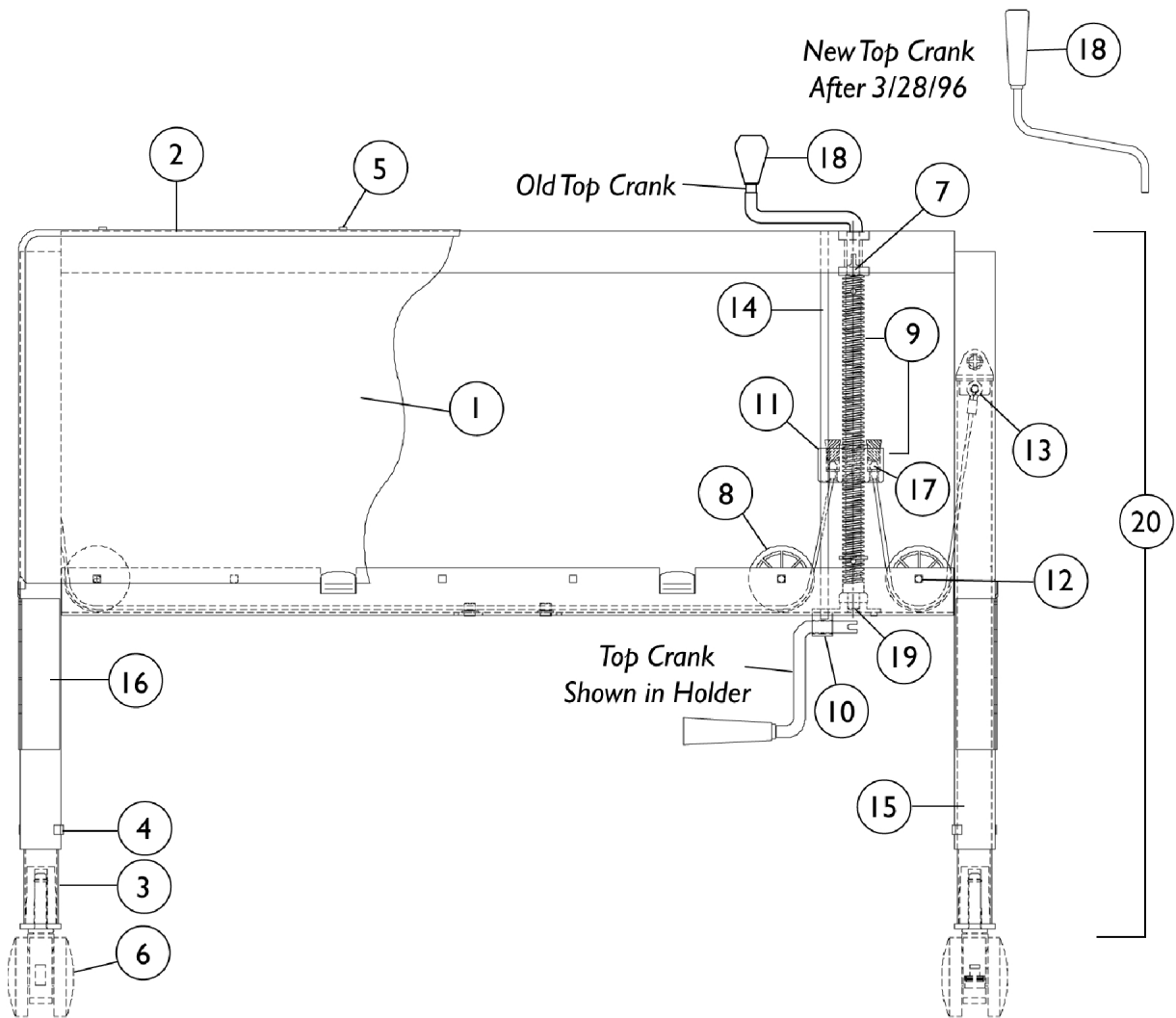

Bed Ends - Manual & Semi Electric

5200

2 Crank Hi / Lo

discontinued 6/03

Item Number	Note	Part Number	Description	Quantity Per	
				Package	Assembly
1		51000M087-NLA	NLA - Panel, Decorative - Head End	1	2
1		51000M076-NLA	NLA - Panel, Decorative, Foot End	1	2
1	E	1116647	Panel, High Impact, Head End	1	2
1	E	1116648	Panel, High Impact, Foot End	1	2
2		51000M255-NLA	NLA - Trim, Decorative - Head End	1	1
2		51000M254-NLA	NLA - Trim, Decorative - Foot End	1	1
3		51000M083	Socket, Caster	1	2
4		51000M581	Guide, Leg	1	4
5		51000M908-NLA	NLA - Screw (#6 x 5/16")	1	12
6	B	51000M000-NLA	NLA - Caster Assembly, Swivel w/ Brake (3")	1	1
6	C	54000M446	Caster Assembly, Swivel w/ Brake (3")	1	1
6	B	51000M001	Caster Assembly, Swivel (3")	1	1
6	C,G	54000M445-NLA	NLA - Caster Assembly, Swivel (3")	1	1
6	B,F	5100M008-NLA	NLA - Package, Caster	1	1
7		51000M589	Bearing, Sleeve	1	1
8		1116651	Pulley, Cable	1	1
9		5200M035-NLA	NLA - Screw Assembly Includes: 1 ea. Cable and Guide Nut, 2 ea. Roll Pin (3/16 x 1-1/8"), 1 ea. Screw (3/4-6 x 15-7/16"), 1 ea. Washer (3/4 x 1-1/16 x 5/64").	1	1
9		5200M024	Screw Assembly - Front Includes: 1 ea. Cable and Guide Nut, 2 ea. Roll Pin (3/16 x 1-1/8"), 1 ea. Screw (3/4-6 x 12-15/16"), 2 ea. Washer (3/4 x 1-1/16 x 5/64").	1	1
9	D	52000M139-NLA	NLA - Kit, Screw Assembly - Head	1	1
9	D	52000M140-NLA	NLA - Kit, Screw Assembly - Foot	1	1
10		53000M737	Holder, Handle	1	1
11		54000M661-NLA	NLA - Stopper, Cork	1	1
12		53000M989-NLA	NLA - Rivet, Square Head	1	3
13		51000M064	Spring, Leg Retaining	1	2
14		51000M088-NLA	NLA - Rod, Guide - Long	1	1
14		51000M075	Rod, Guide, Foot End, Short	1	1
15		5200M030-NLA	NLA - Inner Leg with Long Cable Assembly	1	1
16		5200M029-NLA	NLA - Inner Leg with Short Cable Assembly	1	1
17		51000M004-NLA	NLA - Washer, Slotted	1	2
18		5200M026	Crank Handle Assembly	1	1
19		51000M277	Bearing, Thrust	1	1
20		52000M216-NLA	NLA - Hi/Lo Head End Assembly without Casters (2 Crank)	1	1

Bed Ends - Manual & Semi Electric

5200

2 Crank Hi / Lo

discontinued 6/03

Item Number	Note	Part Number	Description	Quantity Per	
				Package	Assembly
20		52000M215-NLA	NLA - Foot End Assembly, Hi/Lo without Casters (2 Crank)	1	1
	A	51000M426	S-Clip, Panel	1	1
NOTE: A - Not Shown B - Before 10/94 C - After 9/94 D - Includes Items 9, 11, and 17. E - Two (2) Panels are need PER Bed End. Head End takes two (2) panels and Foot End takes two (2) panels. F - Includes: Two (2) Casters with Brakes and Two (2) Casters without Brakes. G - No Longer Available, replace with 54000M446.					