

Re-Order #	Description	Unit
909207	Econo Alarm	Set
909208	Econo Alarm	3PK
909209	Replacement Magnet & Cord	5PK

Purpose

Alerts caregivers when a patient or resident has exited the wheelchair, geri-chair, or just about any other type of chair. This alarm is not a substitute for proper supervision. Patient or resident must be monitored by caregivers.

IMPROVED... now with multi-directional magnetic alarm activation.

Easy to Use

- Place magnet on alarm.
- Remove alarm compartment cover (Illustration A) and insert supplied 9-volt battery. Replace alarm compartment cover.
- Test battery by removing magnet. If alarm sounds, replace magnet and proceed to the following steps. If it does not sound, check battery connections or replace battery.
- Wheelchair attachment.** The Econo-Alarm may be secured to the wheelchair by using only the spring clip on the back of the alarm, or by means of the clip and supplied Velcro® strap.

Clip only

- Clip the alarm to the back of the wheelchair (Illustration B)
- Secure metal clip at end of cord to back of patient's/resident's shirt or blouse. Use slider to adjust cord to desired length. (Illustration C)

Clip Velcro® strap

- Wrap Velcro® strap around vertical support bar above wheel axel. Insert narrow end through slot in wide end. (Illustration D)
- Pull narrow end through slot so that there is an overlap of about two inches. Press "hook" side against "loop" side to fasten. (Illustration E) Clip alarm unit to Velcro® strap. (Illustration F)
- Secure metal clip at end of cord to back of patient's/resident's shirt or blouse. Use slider to adjust cord to desired length. (Illustration G)

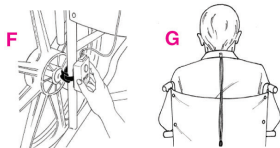
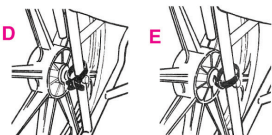
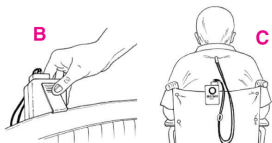
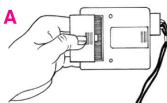

CAUTION: The Skil-Care Personal Alarm (ReOrder# 909211) or the Economy Alarm (ReOrder# 909207) could only affect pacemaker/defibrillator function if held directly in contact with the pacemaker or defibrillator area. Due to the low magnetic pull of the magnet, the products are safe to use if the magnet is kept approximately 2" away from the pacemaker/defibrillator area.

5. Geri-Chair attachment. Secure the Econo-Alarm to the Geri-Chair as follows:

- Wrap the Velcro® strap around the geri-chair push-bar. Insert narrow end through slot in wide end. (Illustration H)
- Pull narrow end through slot so there is an overlap of about two inches. Press “hook” side against “loop” side to fasten. (Illustration I)
- Secure metal clip at end of cord to back of patient’s/resident’s shirt or blouse. Use slider to adjust cord to desired length. (Illustration J)

6. Attachment to other types of chairs. Most chairs have places to which the Econo-Alarm may be attached. Since there are so many types of chairs, it is impossible to provide instructions for them all. The Velcro® strap is adaptable to most. We have provided two illustrations below that show placement of the alarm and strap on chairs other than wheelchairs and geri-chairs. (Illustrations K & L)



Safety Tip

Check alarm before each use. Remove magnet. If alarm is weak or fails to sound, replace 9-volt battery.

Guarantee

Skil-Care's Econo-Alarm is replacement guaranteed against defects in materials or workmanship for a period of six months following date of purchase. Return to dealer for replacement. Do not send to Skil-Care. Battery is not covered by guarantee.