

FloorPro Alarm Mat Wiring Diagrams

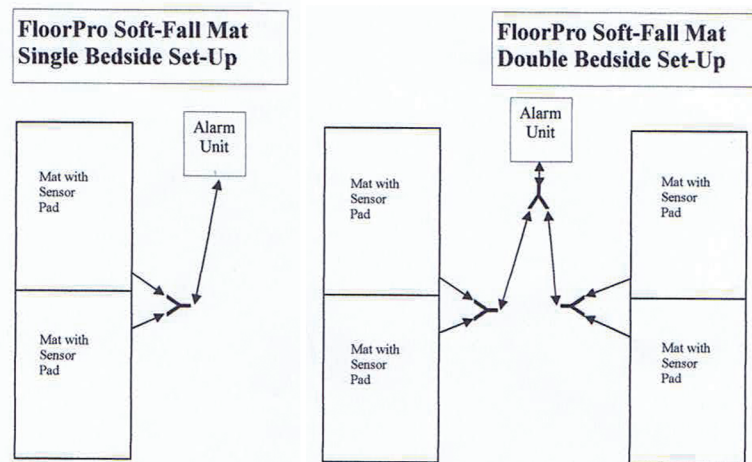

Important Sensor Pad Information

1. The sensor pads may be cleaned with a damp cloth and mild cleanser and/or disinfectant. Do not immerse pad in water or cleaning solution. Do not sterilize.
2. Inspect pads before each use. Replace if damaged
3. Read "Warnings" on sensor pad.

System Operation

1. Since there is no ON/OFF on this alarm it is recommended that the Floor Mat/Fall Mat be slid under the bed, out of the way when transferring the resident in or out of the bed. This will prevent the alarm unit from sounding while standing on the mat.
2. After placing the resident in the bed, place floor pad at the side of the bed, make sure alarm is flashing. Press "Power Test" button. The alarm should sound. If it doesn't, check a/c adaptor connections and re-test. If you are using battery power, replace the battery and re-test.
3. Verify that the LED is blinking. If it is not, check to make certain that the plastic plug is properly inserted in the "Modular Receptacle" on the side of the alarm unit. Note: The blinking LED indicates only that this plug is properly connected. It does not indicate that the sensor pads are properly connected or working.

4. Test the sensor pad by stepping on the floor mat (or mats if you are using the double-mat system). If the alarm fails to sound, check the connections. If connections are secure and alarm still fails to sound, replace the sensor.
5. If you want the alarm to sound only at the nurse's station, move the "In-Room Alarm" switch to the "Off" position. If you want the alarm to sound both at bedside and the nurse's station, place this switch in the "Hi-Low" position
6. Make certain to move Floor Mat/Fall Mat under the bed before you approach the bed, otherwise the alarm will be initiated when step on the mat.

Important: Skil-Care's FloorPro Mat Alarms are designed to work with most patients. However, it is possible that some very lightweight patients may not activate the alarm when they step onto or stand on the mat. Be certain to evaluate the system's operation with each patient.

Keep a copy of these instructions in your procedures manual. If you require additional copies, call Skil-Care at 800-431-2972.



FloorPro™ Bedside Mat Alarms
Soft-Fall Mat & Floor Mat

| Reorder# | Description | Unit |
|----------|--|-------|
| .909286 | Replacement Pad | Each |
| 909275 | FloorPro Soft-Fall Bedside with one 20x30 sensor pad for either left or right side | Set |
| 909276 | FloorPro Soft-Fall Bedside Mat with (2) Two 20x30 sensor pads | Set |
| 909283 | FloorPro Floor Mat Alarm (34x26 pad with sensor and Alarm) | Each |
| 909284 | FloorPro Floor Mat Alarm (Two 34x26 pads with sensor and (1) alarm unit) | Each |
| 909292 | Replacement Alarm Unit with Accessories | Each |
| 909290 | Replacement Sensor Pad/ 180-Day Guarantee | Each |
| 909293 | Replacement Sensor Pads/ 180-Day Guarantee | 4/Pk |
| 909294 | Replacement Sensor Pads/ 180-Day Guarantee | 10/Pk |
| 909403 | Replacement Sensor Pads/ 1 Year Guarantee | Each |
| 909280 | FloorPro Replacement Soft-Fall Bedside Mat | Each |

Skil-Care's FloorPro Alarm reduces false alarms. Placed on the floor next to the bed, the alarm is not activated by patient movement in bed. Unlike on-bed alarms, the FloorPro will not compromise the pressure-relieving qualities of the mattress. It is also far less likely to suffer damage related to patient tampering.

GUARANTEES

1. The FloorPro Safety Alarm Unit is replacement guaranteed for one year following the date of purchase.
2. FloorPro sensor pads are replacement guaranteed for 180 days following the date they are put into service. That date must be noted on the pad for this guarantee to be effective.
3. The Fall Mat/Floor Pad is replacement guaranteed for one year.

PURPOSE

This device alerts caregivers when a patient exits the bed. It is neither designed nor intended to serve as a fall-impact mat.

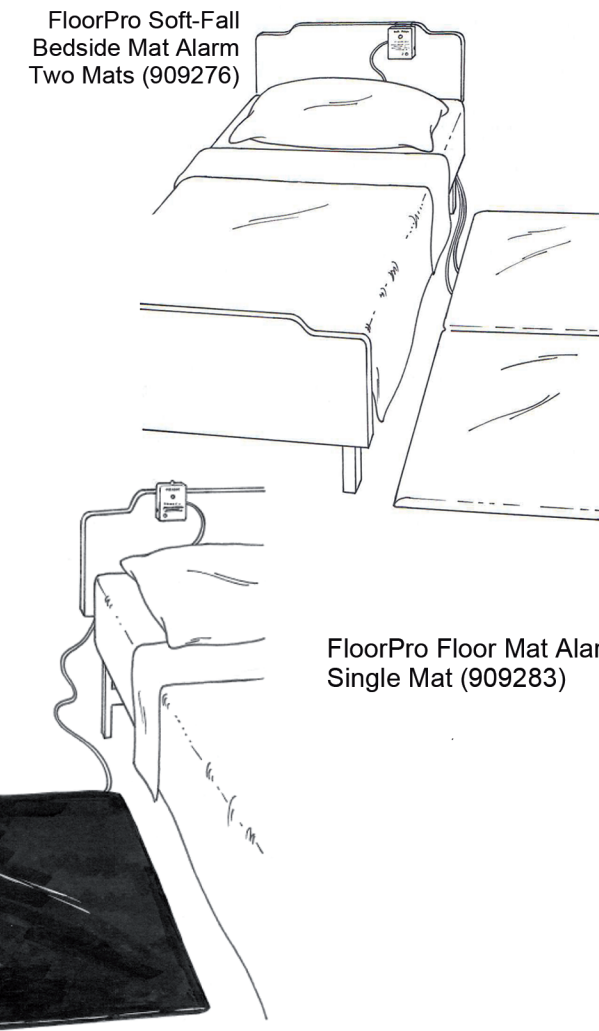

CAUTIONS

1. The FloorPro Alarms are not a substitute for proper supervision. Staff on a regular basis should monitor fall-risk and wander-risk patients.
2. We strongly recommend that the a/c adaptor be used as the power source.
3. If a battery is used as the power source, it must be checked each time the alarm is used to monitor a patient. If weak, replace with two (2) AA batteries.
4. LED should flash when alarm is in standby mode. If LED fails to flash and you are using the a/c adaptor, check connection at wall outlet and alarm unit. If you are using a battery, replace with two (2) AA batteries.
5. Never use the FloorPro Alarm unit with an on-bed sensor pad. It is not designed or intended to be used with any type of sensor other than the FloorPro sensor.

FloorPro™ Safety Alarm Unit Component Identification

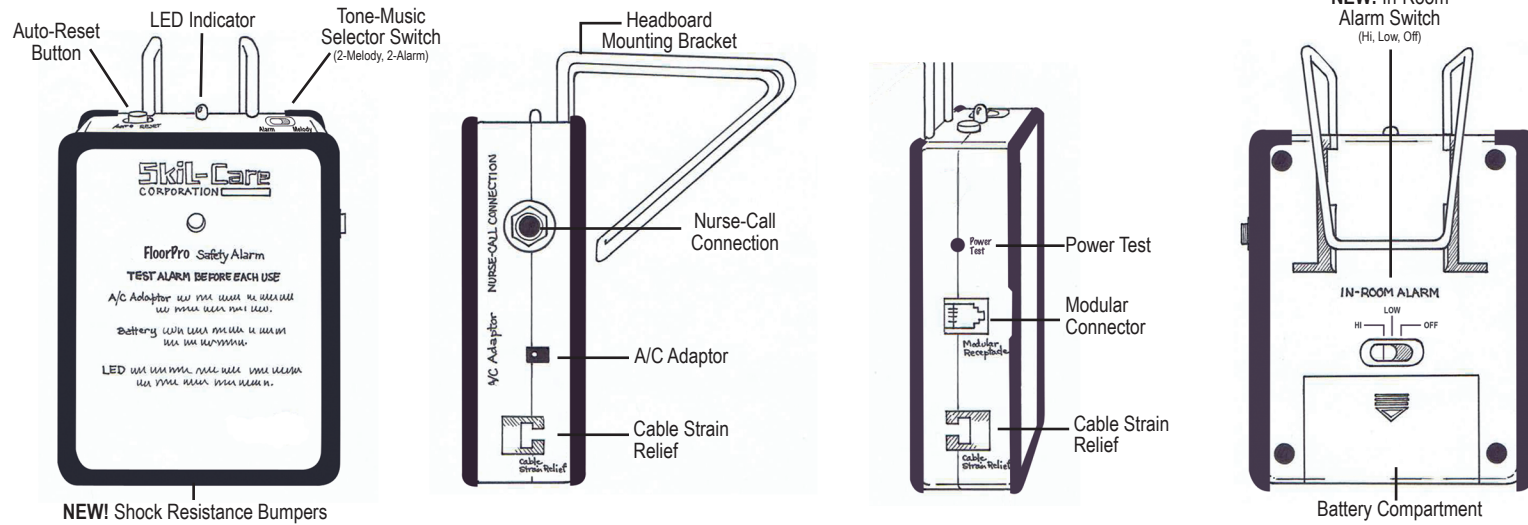

Alarm Conditions

- Alarm sounds** when resident lands or stands on Floor Mat
Note: Alarm will continue ringing when floor sensor is activated. It will continue to ring until the reset button is pushed, even if resident comes off the floor sensor.
- Alarm sounds** when batteries are low.

LED Conditions

| Condition | Status |
|--|-----------------|
| When batteries are installed (not flash) | Green Steady |
| Sensor pad plugged in and Sensing | Green/Red Flash |
| Alarm ring | Red Flash |

Features:

- **Low battery alert** - alarm sounds when battery is low
- **Sounds** - two tone buzzer, high (90db), low (80db) and two tone melody, high (90db), low (80db)
- Battery Test
- Auto-Reset
- Alarm sensor interface uses modular connector
- Cable strain relief (2)
- Shock resistance bumpers enhance alarm durability
- A/C Battery Power
- If A/C is plugged in, it will override batteries
- If A/C is plugged in, and power fails batteries will override A/C, if installed

Nurse-Call Interface

The FloorPro Safety Alarm is easily connected to the nurse-call system in your facility. It is designed to permit the regular use of the resident's nurse-call button without activating the alarm. You may choose to have the alarm sound at bedside and the nurse's station, or to signal only at the nurse's station. See instructions below.

- Set the "In-Room Alarm" switch on the back of the alarm to the "Hi" or Low" positions if you want the alarm to sound both at bedside and the nurse's station (Illustration C1). Set the switch to the "Off" position for the alarm to signal only at the nurse's station (Illustration C2).
Important: Set the switch to the "Hi" or "Low" positions when testing the alarm. There will be no audible signal when the "In-Room" switch is set to "Off".
- Inset one end of the supplied nurse-call interface cable into the receptacle labeled "Nurse-Call Connection" located on the right side of the alarm unit (Illustration D). Mount alarm unit on headboard. To prevent resident tampering, alarm unit should face the wall.
- Remove nurse-call button cable from the wall socket and insert Y-connector (Illustration E).
- Plug both the nurse-call button cable and the alarm nurse-call interface cable into the Y-connector (Illustration F). Test operation of both the resident's nurse-call button and the alarm unit's nurse-call interface by:
 - Pressing resident's nurse-call button and verifying that the signal is received at nurse's station; and
 - Pressing "Power-Test" button on the left side of the alarm unit and verifying that the signal is received at the nurse's station.

If either or both fail to work, check all connections and retest.

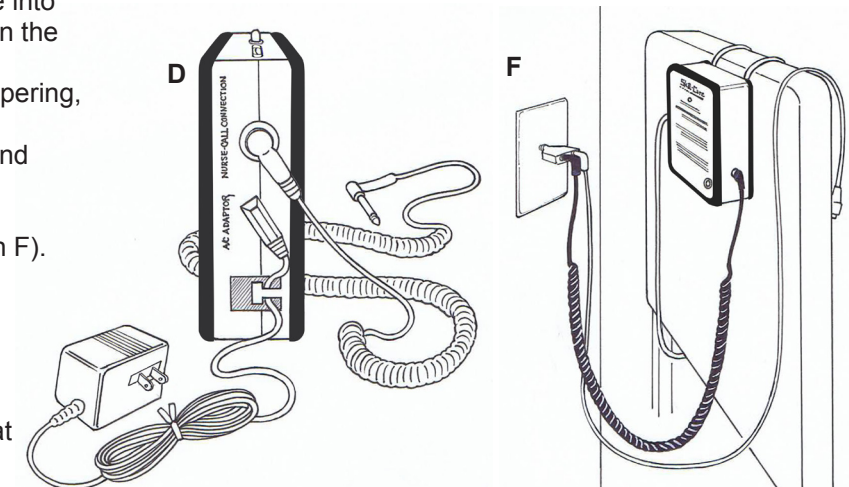
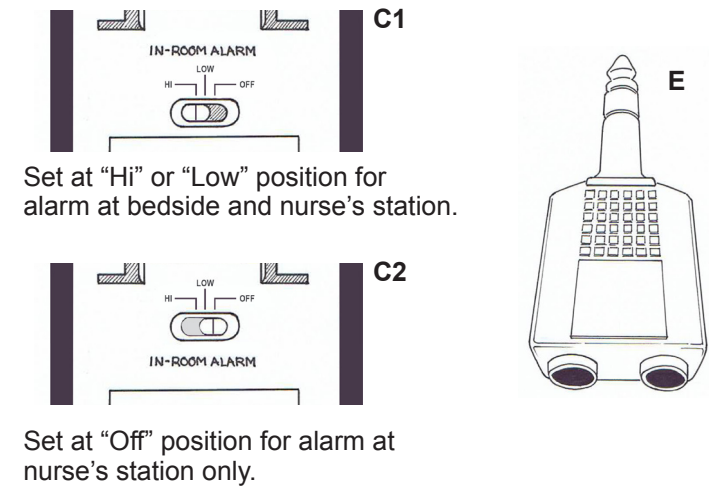

INSTALLATION

This information pertains to the FloorPro alarm and fall mats with sensors or floor pads.

Power Source

1. A/C Adaptor

Tuck A/C adaptor cord under the Cable Strain Relief tab and plug into socket labeled "A/C Adaptor" (Illustration A). Plug adaptor into wall outlet LED will be steady. Test by pressing "Power-Test" button. When testing, make certain that the "In-Room Alarm" switch on the back of the alarm unit is set to the "Hi" or "Low" positions (Illustration B). There will be no audible signal if this switch is in the "Off" position. If alarm doesn't sound, check adaptor connections.

2. Battery

- Remove battery compartment cover and install two AA batteries LED is steady. Battery operation is recommended only in the event of a power failure. The alarm will automatically switch to battery operation if A/C power fails or if A/C adaptor becomes disconnected.
- Test battery by pressing the "Power-Test" button on the left side of the alarm unit LED will flash. Check the "In-Room Alarm" switch on the back of the alarm unit which should be set to the "Hi" or "Low" positions (Illustration B). The alarm signal will not sound if the switch is set to the "Off" position. If alarm fails to sound, check battery connections and retest. If alarm still doesn't sound, replace both AA batteries.

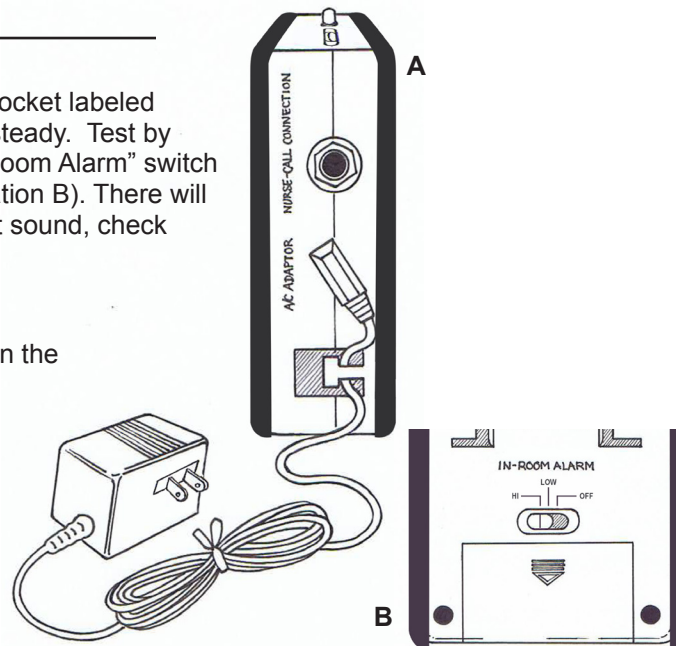

Floor Mat with Sensor Pad

Important: Instructions are provided below for both single- and double-mat FloorPro systems. Keep in mind that a double-mat system is required to monitor a patient who can exit from both sides of the bed.

Single-Mat System (See wiring diagram on page 4)

- Make certain that the sensor pad is inserted into the sleeve on the bottom of the floor mat. (Illustration G)
- Place the mat next to the bed with notice "This Side Up" facing up.
- The telephone-style wire extending from the sensor pad is terminated with a male modular connector. Insert the male modular connector in the "Modular Receptacle" on the left side of the alarm unit (Illustration H, next page)

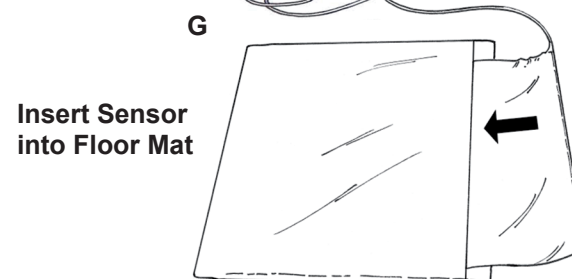

Double-Mat System (See wiring diagram on page 4)

- Make certain that the two sensor pads are inserted into the two sleeves on the bottom of the floor mats. (Illustration G)
- Place the mats on the left and right sides of the bed with notice "This Side Up" faced up.
- The double mat system includes a double-jack adaptor with pre-attached wire and male modular connector. Insert the male modular connector into the "Modular Receptacle" on the left side of the alarm unit (Illustration I, next page).
- The telephone-style wires extending from the sensor pads are each terminated with a male modular connector. Insert these male modular connector into the double-jack adaptor attached to the alarm unit (Illustration J, next page).

